

SITE 2

30 homes

Site assessment:

suitable with minor constraints
- adjacent to conservation area
but screened by trees

Deliverability issues:

- Southern section of site could be used for High School extension
- Vehicle access to Farriers Close requires agreement with private landowner

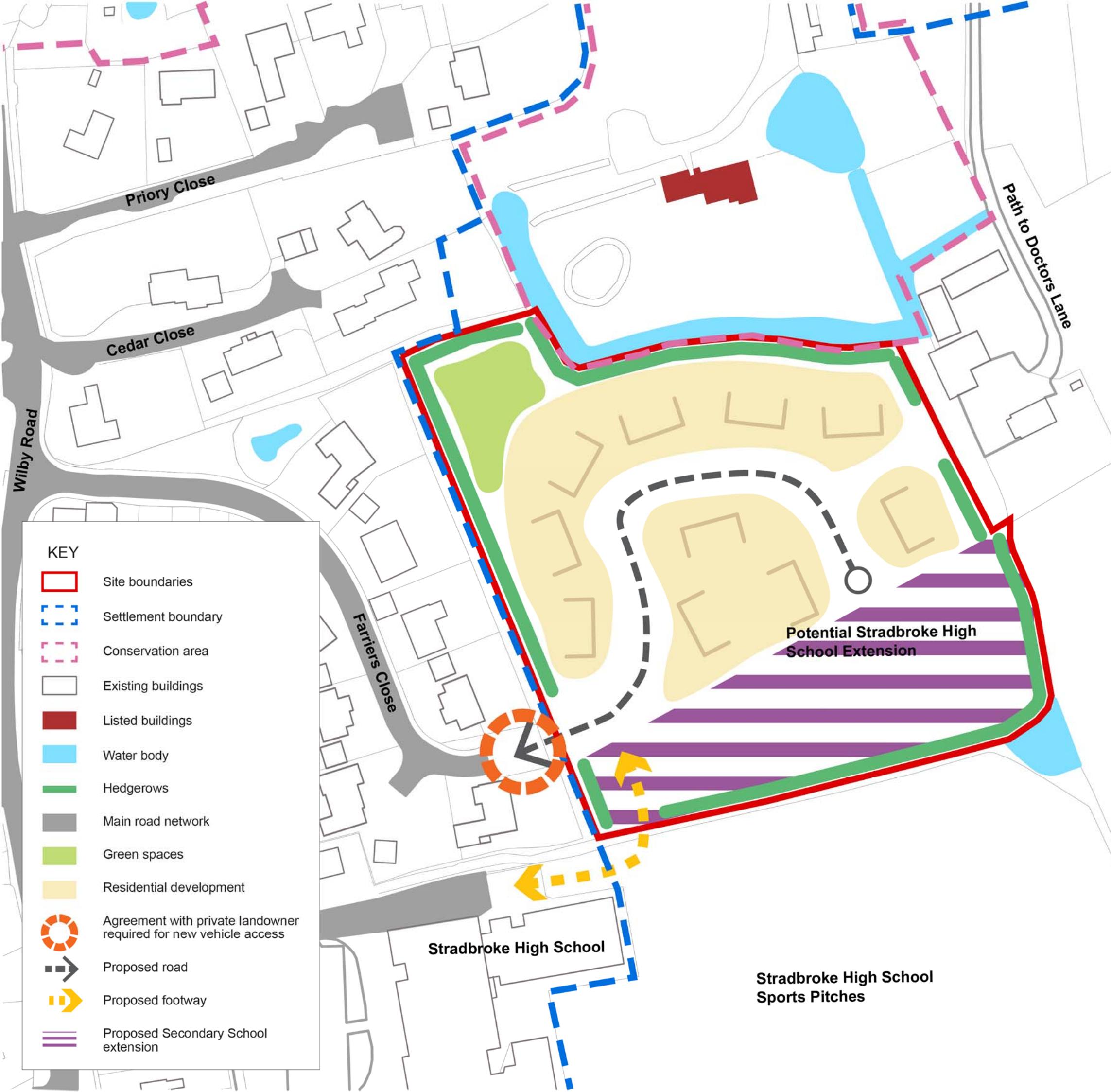

KEY

- Site boundaries
- Settlement boundary
- Conservation area
- Existing buildings
- Listed buildings
- Water body
- Hedgerows
- Main road network
- Green spaces
- Residential development
- Agreement with private landowner required for new vehicle access
- Proposed road
- Proposed footway
- Proposed Secondary School extension

